Report To:	ENVIRONMENT & REGENERATION COMMITTEE	Date:	5 March 2020
Report By:	CORPORATE DIRECTOR, ENVIRONMENT, REGENERATION & RESOURCES	Report No:	LP/015/20
Contact Officer:	LINDSAY CARRICK	Contact No:	01475 712114
Subject:	PROPOSED TRAFFIC REGULATION ORDER – DISABLED PERSONS’ PARKING PLACES (ON STREET) ORDER No. 1 2020		

1.0 PURPOSE

- 1.1 Local Authorities are empowered to make Orders under the Road Traffic Regulation Act 1984 as amended and under the Council’s Scheme of Administration the Shared Head of Service Roads is responsible for the making, implementation and review of Traffic Management Orders and Traffic Regulation Orders.
- 1.2 The purpose of the report is to introduce the proposed Traffic Regulation Order – The Inverclyde Council Disabled Persons’ Parking Places (On-Street) Order No. 1 2020.

2.0 SUMMARY

- 2.1 In order to comply with The Disabled Persons’ Parking Places (Scotland) Act 2009, Section 5, it is proposed to introduce a Traffic Regulation Order to accompany the provision of parking places for the disabled. This will restrict parking to drivers displaying a Disabled Person’s Badge only and will enable enforcement of such restrictions. The proposed Order will also revoke those parking places no longer required in order to maximise street parking capacity.
- 2.2 The provision of on-street parking places for use by disabled drivers, who are the holders of a Disabled Person’s Badge, is regulated by The Disabled Persons’ Parking Places (Scotland) Act 2009. Inverclyde Council is required to promote a Traffic Regulation Order to regulate the use of such parking places.

3.0 RECOMMENDATIONS

- 3.1 That the Committee recommends to the Inverclyde Council the making of the Traffic Regulation Order – Disabled Persons’ Parking Places (On-Street) Order No. 1 2020 and remits it to the Shared Head of Service Roads and the Head of Legal and Property Services to arrange for its implementation.

4.0 BACKGROUND

- 4.1 There are currently no Traffic Regulation Orders that exist at the locations shown in the schedule which would prohibit the allocation of parking places for Disabled Person’s Badge holders.
- 4.2 No objections were received to the proposed Order.
- 4.3 The Committee is asked to note that, if approved, the Order may not be implemented until the making of the Order has been advertised to allow any persons who so wish a period of six weeks to question the validity of the Order in terms of the Road Traffic Regulation Act 1984.

6.0 IMPLICATIONS

6.1 Finance

Financial Implications:

One off Costs

Cost Centre	Budget Heading	Budget Years	Proposed Spend this Report	Virement From	Other Comments
N/A					

Annually Recurring Costs/ (Savings)

Cost Centre	Budget Heading	With Effect from	Annual Net Impact	Virement From (If Applicable)	Other Comments
N/A					

6.2 Legal

There are no legal implications arising from this report.

6.3 Human Resources

There are no HR implications arising from this report.

6.4 Equalities

Equalities

(a) Has an Equality Impact Assessment been carried out?

	YES
X	NO – This report does not introduce a new policy, function or strategy or recommend a substantive change to an existing policy, function or strategy. Therefore, no Equality Impact Assessment is required

(b) Fairer Scotland Duty

If this report affects or proposes any major strategic decision:-

Has there been active consideration of how this report's recommendations reduce inequalities of outcome?

	YES – A written statement showing how this report's recommendations reduce inequalities of outcome caused by socio-economic disadvantage has been completed.
X	NO

(c) Data Protection

Has a Data Protection Impact Assessment been carried out?

	YES – This report involves data processing which may result in a high risk to the rights and freedoms of individuals.
X	NO

6.5 Repopulation

There are no repopulation implications arising from this report.

7.0 CONSULTATIONS

7.1 The proposals have been advertised in the Greenock Telegraph and full details of the proposals have been made available for public inspection during normal office hours at the offices of the Shared Head of Service Roads, the Head of Legal and Property Services and at Central, Port Glasgow, Southwest and Gourock Libraries. A copy of the draft Order forms appendix 1.

Appendix 1

8.0 BACKGROUND PAPERS

8.1 None

THE INVERCLYDE COUNCIL
DISABLED PERSONS' PARKING PLACES
(ON-STREET) ORDER NO.1 2020
TRAFFIC REGULATION ORDER

THE INVERCLYDE COUNCIL
DISABLED PERSONS' PARKING PLACES (ON-STREET)
ORDER NO.1 2020

The Inverclyde Council in exercise of the powers conferred on them by Section 32(1) of the Road Traffic Regulation Act 1984 ("the Act") and of all other enabling powers and after consultation with the Chief Constable of Police Scotland in accordance with Part III of Schedule 9 to the Act hereby make the following Order.

1. This Order may be cited as "The Inverclyde Council Disabled Persons' Parking Places (On-Street) Order No. 1 2020" and shall come into operation on #####.

2. In this Order the following expressions have the meanings hereby assigned to them:-

"Council" means The Inverclyde Council or its successors as Roads Authority;

"disabled person's badge" means:

- (a) a badge issued under Section 21 of the Chronically Sick and Disabled Persons Act 1970 (as amended);
 - (b) a badge issued under a provision of the law of Northern Ireland corresponding to that section; or
 - (c) a badge issued by any member State other than the United Kingdom for purposes corresponding to the purposes for which badges under that section are issued;
- and which has not ceased to be in force;

"disabled person's vehicle" means a vehicle lawfully displaying a disabled person's badge;

"parking attendant" means a person employed in accordance with Section 63A of the Act to carry out the functions therein;

"parking place" means an area of land specified by number and name in Columns 1 and 2 in the Schedule to this Order;

"traffic sign" means a sign prescribed or authorised under Section 64 of the Act; and

"vehicle" unless the context otherwise requires, means a vehicle of any description and includes a machine or implement of any kind drawn or propelled along roads whether or not by mechanical power.

3. The Schedule titled "Disabled Persons' Parking Places (On Street) Order No. 1 2020" forms the Schedule to this Order.

4. Each area of road which is described in the Schedule Part 1 to this Order and the plans relative to this Order is hereby designated as a parking place.

5. The parking places shall only be used for the leaving of disabled persons' vehicles displaying a valid disabled person's badge.

6. The limits of each parking place shall be indicated on the carriageway as prescribed by The Traffic Signs Regulations and General Directions 2016, as amended.
7. Every vehicle left in any parking place shall stand such that no parking place is occupied by more than one vehicle and that every part of the vehicle is within the limits of the parking place provided that, where the length of a vehicle precludes compliance with this paragraph, such vehicle shall be deemed to be within the limits of a parking place if:-

the extreme front portion or, as the case may be, the extreme rear portion of the vehicle is within 300mm of an indication on the carriageway provided under this Order in relation to the parking place; and

the vehicle, or any part thereof, is not within the limits of any adjoining parking place.
8. Any person duly authorised by the Council or a police officer in uniform or a traffic warden or parking attendant may move or cause to be moved in case of any emergency, to any place they think fit, vehicles left in a parking place.
9. Any person duly authorised by the Council may suspend the use of a parking place or any part thereof whenever such suspension is considered reasonably necessary:-

for the purpose of facilitating the movement of traffic or promoting its safety;

for the purpose of any building operation, demolition, or excavation in or adjacent to the parking place or the laying, erection, alteration, removal or repair in or adjacent to the parking place of any sewer or of any main, pipe, apparatus for the supply of gas, water electricity or of any telecommunications apparatus, traffic sign or parking meter;

for the convenience of occupiers of premises adjacent to the parking place on any occasion of the removal of furniture from one office or dwellinghouse to another or the removal of furniture from such premises to a depository or to such premises from a depository;

on any occasion on which it is likely by reason of some special attraction that any street will be thronged or obstructed; or

for the convenience of occupiers of premises adjacent to the parking place at times of weddings or funerals or on other special occasions.
10. A police officer in uniform may suspend for not longer than twenty four hours the use of a parking place or part thereof whenever such suspension is considered reasonably necessary for the purpose of facilitating the movement of traffic or promoting its safety.

11. This Order insofar as it relates to the parking places to be revoked (R) and amended, as specified in the Schedule Part 2 to this Order, partially revokes and amends The Inverclyde Council Disabled Persons' Parking Places (On-Street) Order Nos. 02/2009, 04/2010, 04/2011, 04/2013, 01/2016, 04/2015 and 02/2017 respectively.

Sealed with the Common Seal of The Inverclyde Council and subscribed for them and on their behalf by #####, Proper Officer, on the ##### day of #####, Two Thousand and #####.

DRAFT

INVERCLYDE COUNCIL

**DISABLED PERSONS' PARKING PLACES (ON-STREET)
ORDER No.1 2020**

Rev A

SCHEDULE (Part 1)

All and whole that area of ground as described in Column 2 in the table below:

Column 1	Column 2
<u>Ref No.</u>	<u>Address of Disabled Person's Parking Place to be created "ex-adverso"</u>
1886	4 Glen Douglas Place, Greenock
1962	14 Ann Street, Greenock
1970	22 Arran Avenue, Port Glasgow
1975	33 Trafalgar Street, Greenock
1976	11 Forsyth Street, Greenock
1978	1 West Shaw Street, Greenock
1979	45 Prospecthill Street, Greenock
1980	25 Ashton Road, Gourock
1981	14 Mavis Road, Greenock
1985	Bank Street, Greenock
1987	9 Collingwood Terrace, Gourock
1990	63 Larkfield Road, Gourock
1991	38 John Street, Gourock

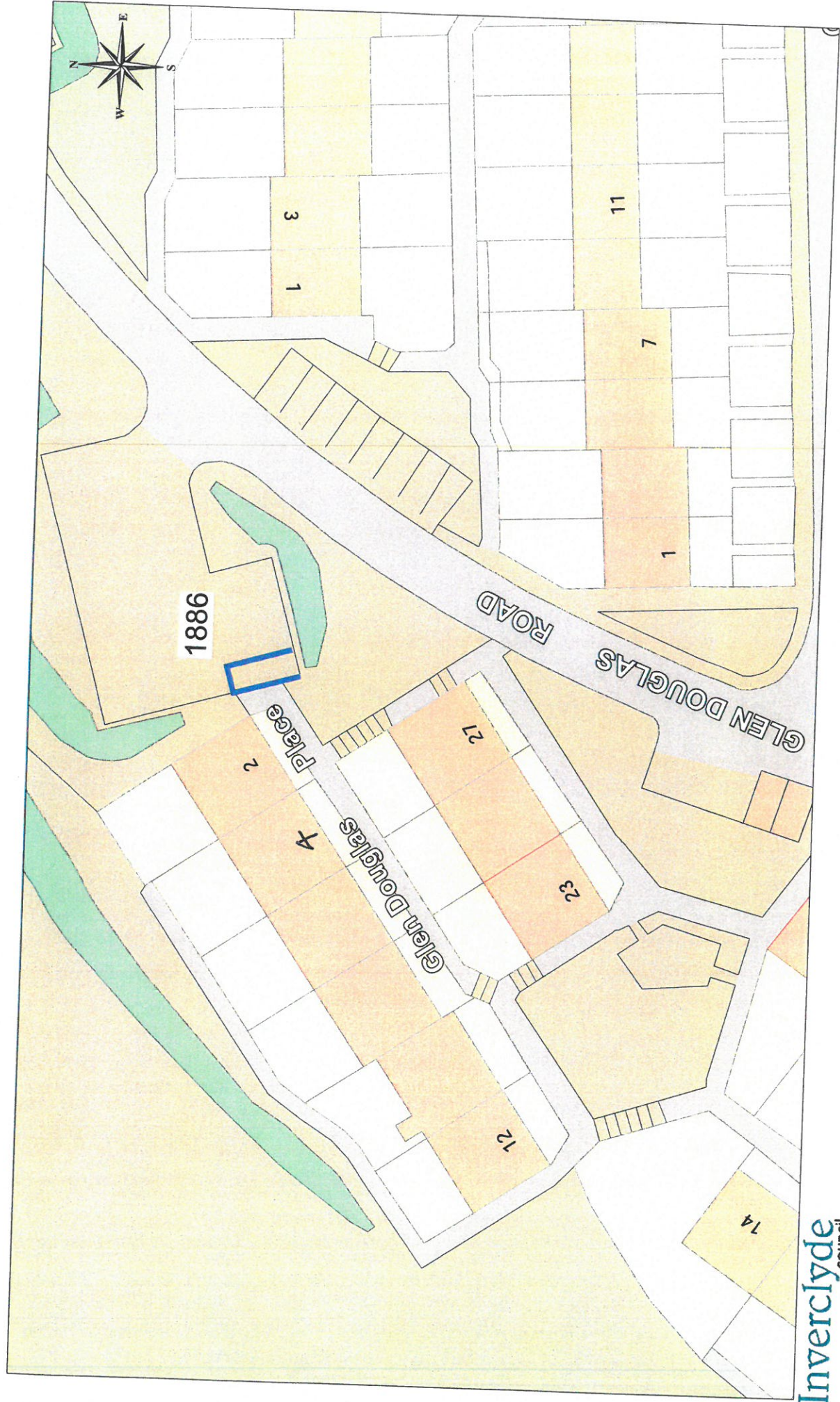

Reproduced by permission of Ordnance Survey on behalf of HMISO.
 ©Crown copyright and database right 2019.
 All rights reserved.

Inverclyde
 council

Roads & Transportation

Environment, Regeneration & Resources
 Corporate Director: Scott Allan BSc., C.Eng., M.I.C.E.

Municipal Buildings
 Clyde Square
 Greenock, PA15 1LY
 Tel: 01475 712712
 Fax: 01475 712731
 scott.allan@inverclyde.gov.uk

DISABLED PERSONS' PARKING PLACE
 4 GLEN DOUGLAS PLACE, GREENOCK
 PLACE No. 1886

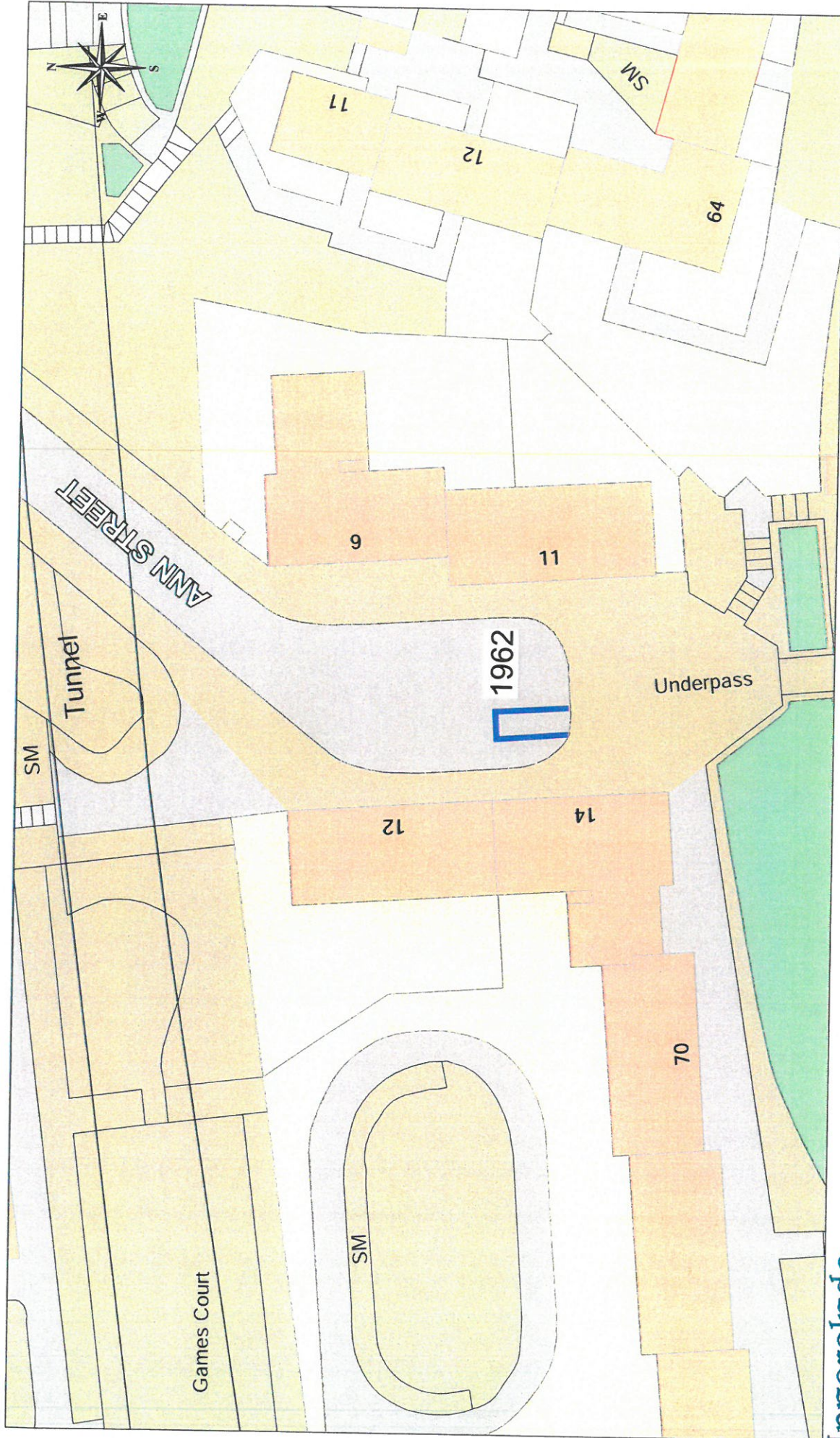

Reproduced by permission of Ordnance Survey on behalf of HMSO.
 ©Crown copyright and database right 2019.
 All rights reserved.
 Ordnance Survey Licence number 10023421.

Inverclyde
 council
 Roads & Transportation
 Environment, Regeneration & Resources
 Corporate Director: Scott Allan BSc., C.Eng., M.I.C.E.
 Municipal Buildings
 Clyde Square
 Greenock, PA15 1LY
 Tel: 01475 712712
 Fax: 01475 712731
 scott.allan@inverclyde.gov.uk

DISABLED PERSONS' PARKING PLACE
 14 ANN STREET, GREENOCK
 PLACE No. 1962

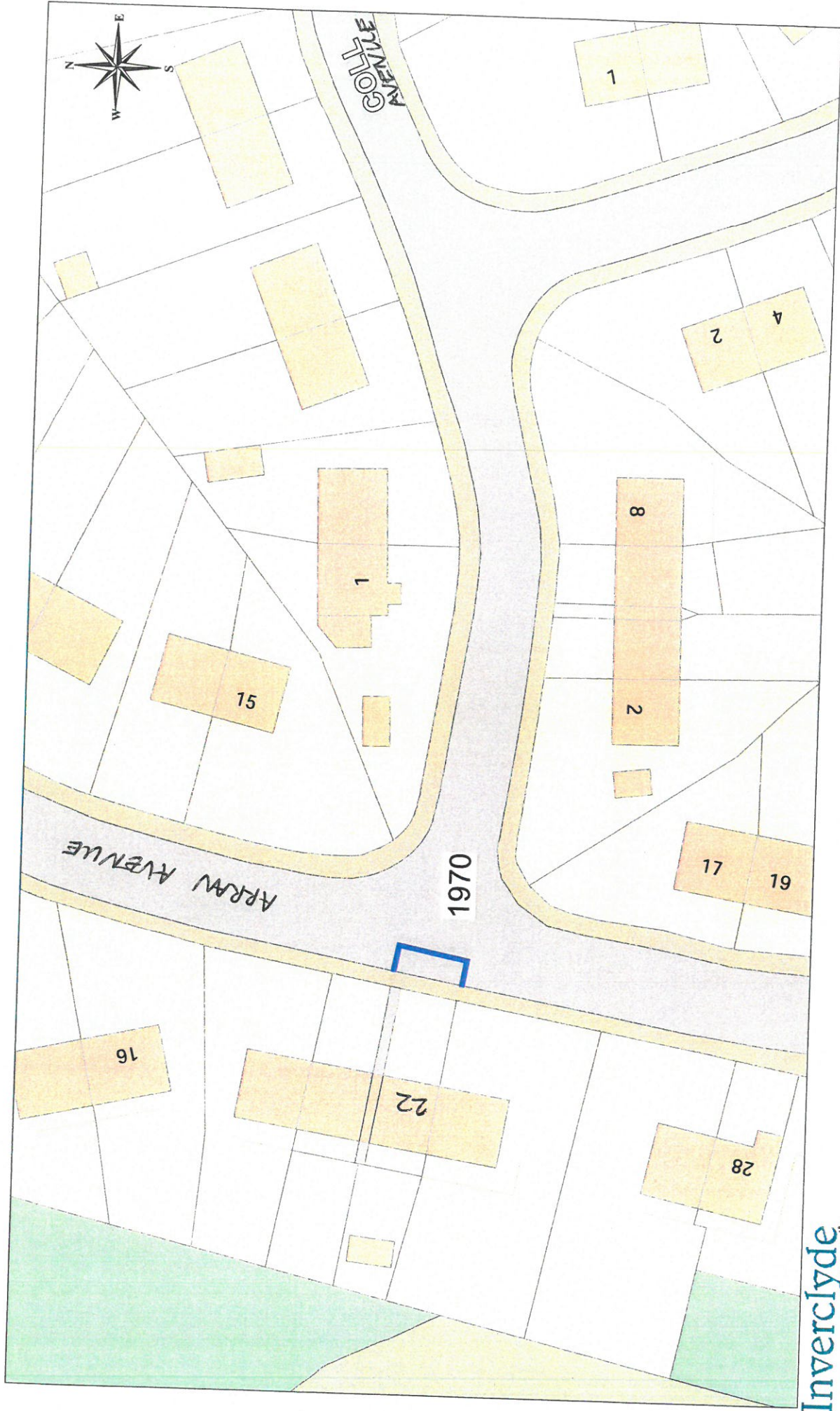

Reproduced by permission of Ordnance Survey on behalf of HMSO.
 ©Crown copyright and database right 2019.
 All rights reserved.

Inverclyde
 council

Roads & Transportation

Environment, Regeneration & Resources
 Corporate Director: Scott Allan BSc., C.Eng., M.I.C.E.

Municipal Buildings
 Clyde Square
 Greenock, PA15 1LY
 Tel: 01475 712712
 Fax: 01475 712731
 scott.allan@inverclyde.gov.uk

DISABLED PERSONS' PARKING PLACE
 22 ARRAN AVENUE, PORT GLASGOW
 PLACE No. 1970

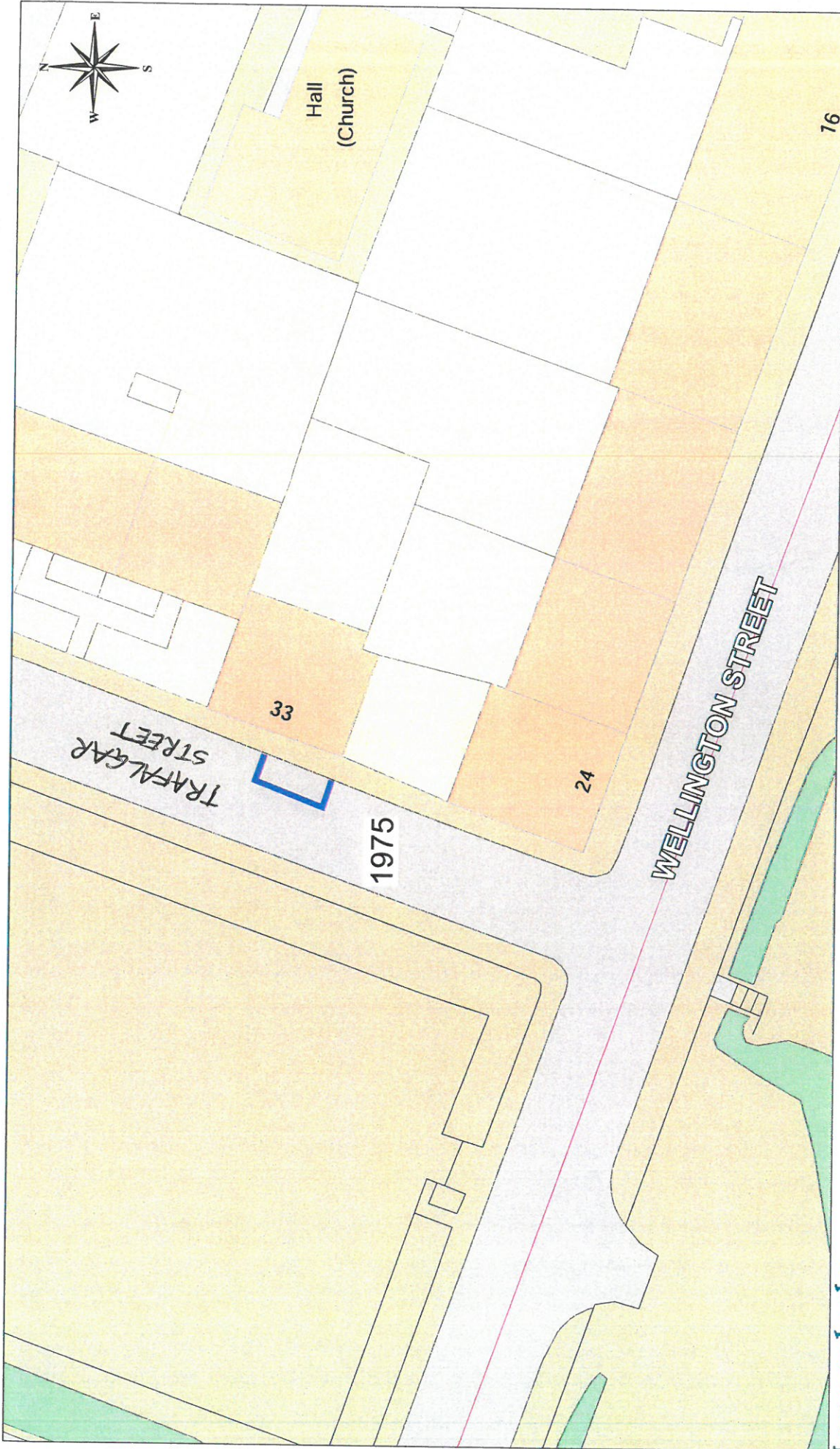

Reproduced by permission of Ordnance Survey on behalf of HMSO.
 ©Crown copyright and database right 2019.
 All rights reserved.
 Ordnance Survey Licence number 10023421.

Inverclyde council
Roads & Transportation
 Environment, Regeneration & Resources
 Corporate Director: Scott Allan BSc., C.Eng., M.I.C.E.
 Municipal Buildings
 Clyde Square
 Greenock, PA15 1LY
 Tel: 01475 712712
 Fax: 01475 712731
 scott.allan@inverclyde.gov.uk

DISABLED PERSONS' PARKING PLACE
33 TRAFALGAR STREET, GREENOCK
PLACE No. 1975



Reproduced by permission of Ordnance Survey on behalf of HMSO.
 © Crown copyright and database right 2010.
 All rights reserved.
 Ordnance Survey Licence number 10023421.

DISABLED PERSONS' PARKING PLACE
11 FORSYTH STREET, GREENOCK
PLACE No. 1976

Inverclyde council
Roads & Transportation
 Environment, Regeneration & Resources
 Corporate Director: Scott Allan BSc., C.Eng., M.I.C.E.
 Municipal Buildings
 Clyde Square
 Greenock, PA15 1LY
 Tel: 01475 71272
 Fax: 01475 71273
 scott.allan@inverclyde.gov.uk

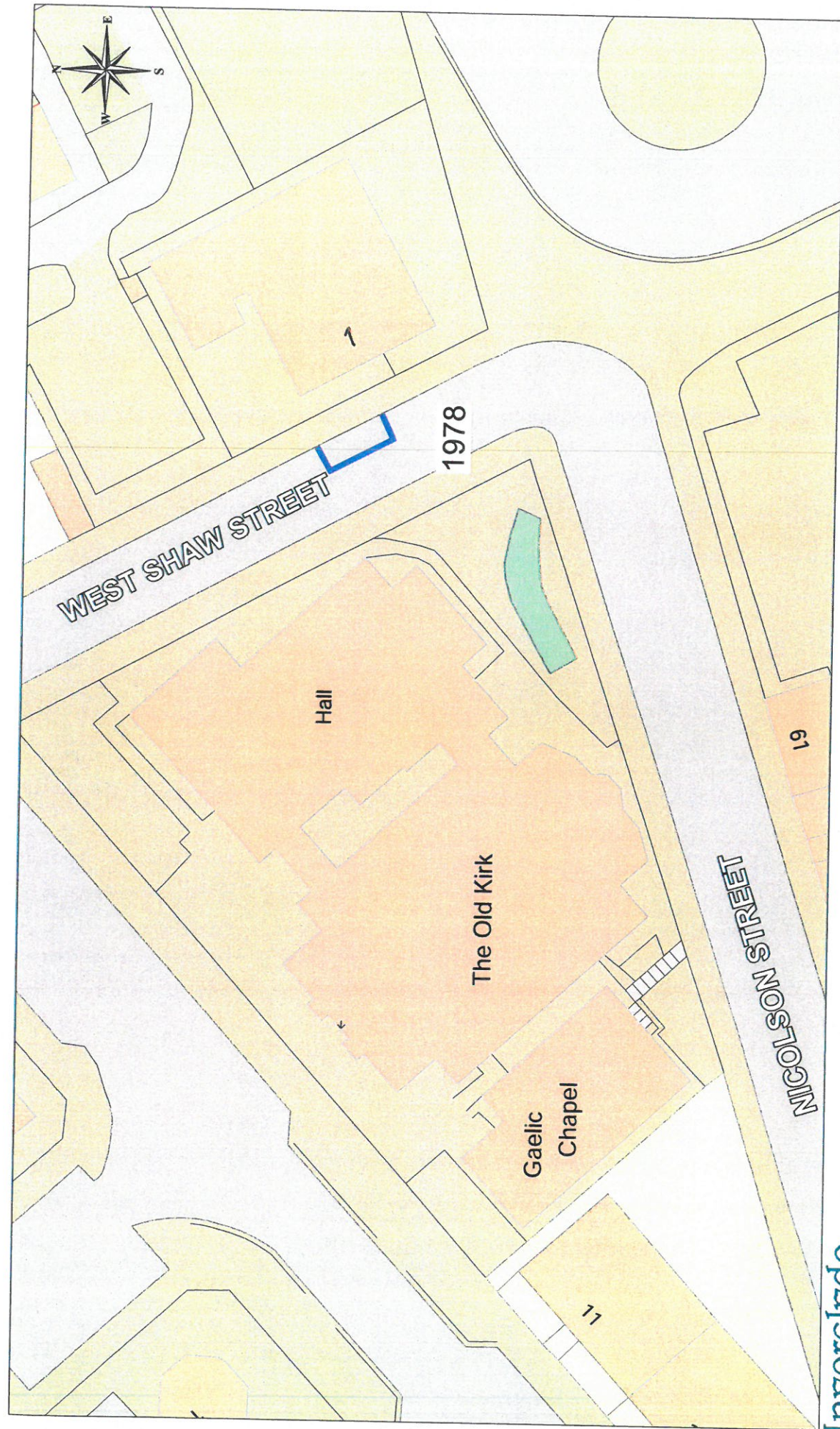
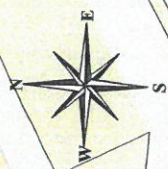

Reproduced by permission of Ordnance Survey on behalf of HMSO.
©Crown copyright and database right 2019.
All rights reserved.
Ordnance Survey Licence number 10023421.

Inverclyde
council

Roads & Transportation

Environment, Regeneration & Resources
Corporate Director: Scott Allan BSc., C.Eng., M.I.C.E.
Municipal Buildings
Clyde Square
Greenock, PA15 1LY
Tel: 01475 712712
Fax: 01475 712731
scott.allan@inverclyde.gov.uk

DISABLED PERSONS' PARKING PLACE
1 WEST SHAW STREET, GREENOCK
PLACE No. 1978

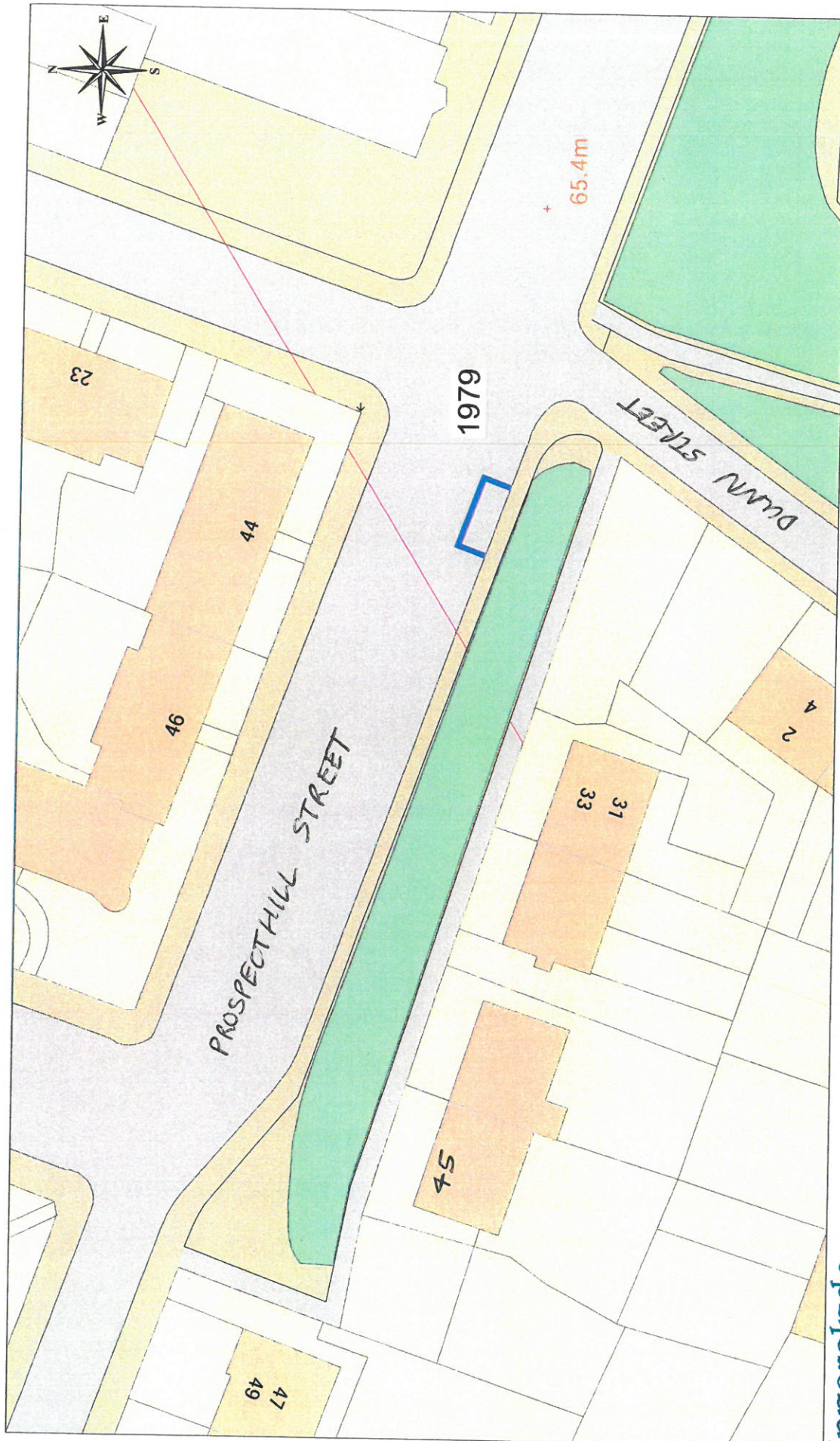

Reproduced by permission of Ordnance Survey on behalf of HMSO.
 ©Crown copyright and database right 2019.
 All rights reserved.
 Ordnance Survey Licence number 10023421.

Inverclyde
 council
 Roads & Transportation

Environment, Regeneration & Resources
 Corporate Director: Scott Allan BSc., C.Eng., M.I.C.E.
 Municipal Buildings
 Clyde Square
 Greenock, PA15 1LY
 Tel: 01475 712712
 Fax: 01475 712731
 scott.allan@inverclyde.gov.uk

DISABLED PERSONS' PARKING PLACE
 45 PROSPECTHILL STREET, GREENOCK
 PLACE No. 1979

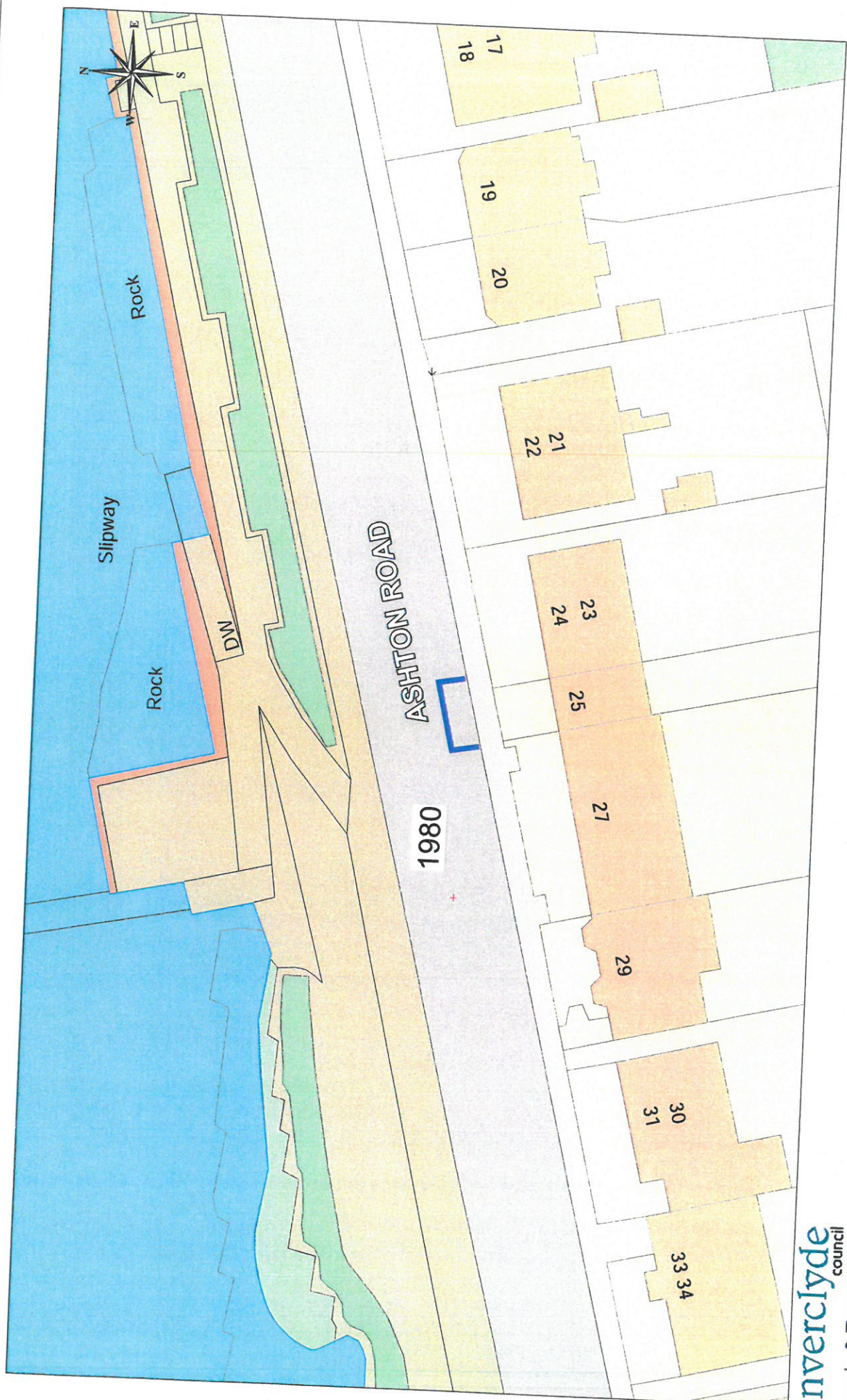

Reproduced by permission of Ordnance Survey on behalf of HMSO.
 ©Crown copyright and database right 2019.
 All rights reserved.

DISABLED PERSONS' PARKING PLACE
 25 ASHTON ROAD, GOUROCK
 PLACE No. 1980

Inverclyde council
 Roads & Transportation
 Environment, Regeneration & Resources
 Corporate Director: Scott Allan BSc., C.Eng., M.I.C.E.
 Municipal Buildings
 Clyde Square
 Greenock, PA15 1LY
 Tel: 01475 712742
 Fax: 01475 712731
 scott.allan@inverclyde.gov.uk



LINNET ROAD

13

24

14 12

1981

MAVIS ROAD

23

13 15

17



Reproduced by permission of Ordnance Survey on behalf of HMSO.

©Crown copyright and database right 2019.

All rights reserved.

Ordnance Survey Licence number 10023421.

DISABLED PERSONS' PARKING PLACE

14 MAVIS ROAD, GREENOCK

PLACE No. 1981

Inverclyde
council

Roads & Transportation

Environment, Regeneration & Resources
Corporate Director: Scott Allan BSc., C.Eng., M.I.C.E

Municipal Buildings
Clyde Square
Greenock, PA15 1LY
Tel: 01475 712712
Fax: 01475 712731
scott.allan@inverclyde.gov.uk

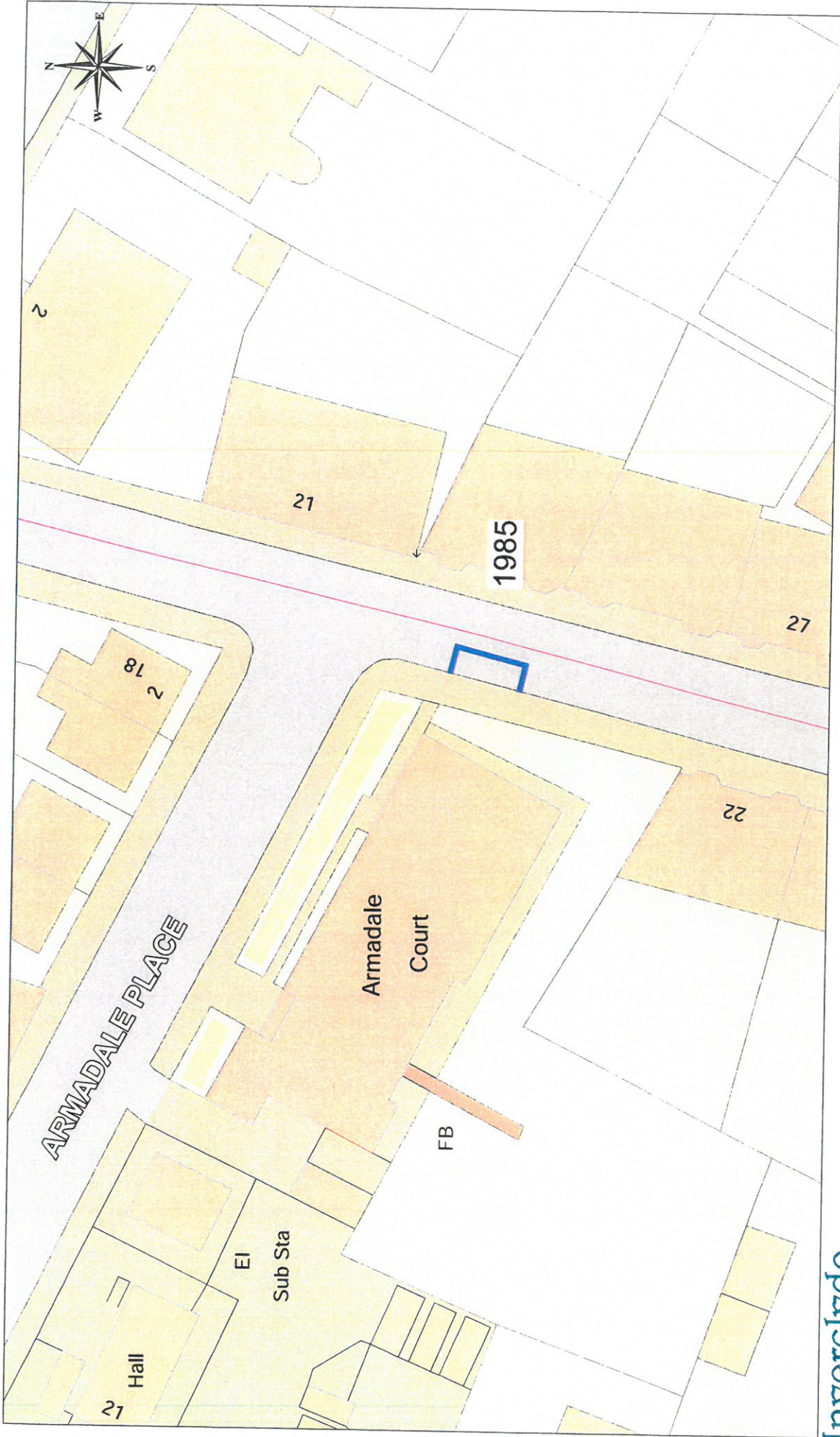

Reproduced by permission of Ordnance Survey on behalf of HMSO.
 ©Crown copyright and database right 2019.
 All rights reserved.
 Ordnance Survey Licence number 10023421.

Inverclyde
 council

Roads & Transportation

Environment, Regeneration & Resources
 Corporate Director: Scott Allan BSc., C.Eng., M.I.C.E.
 Municipal Buildings
 Clyde Square
 Greenock, PA15 1LY
 Tel: 01475 712712
 Fax: 01475 712731
 scott.allan@inverclyde.gov.uk

DISABLED PERSONS' PARKING PLACE
 BANK STREET, GREENOCK
 PLACE No. 1985

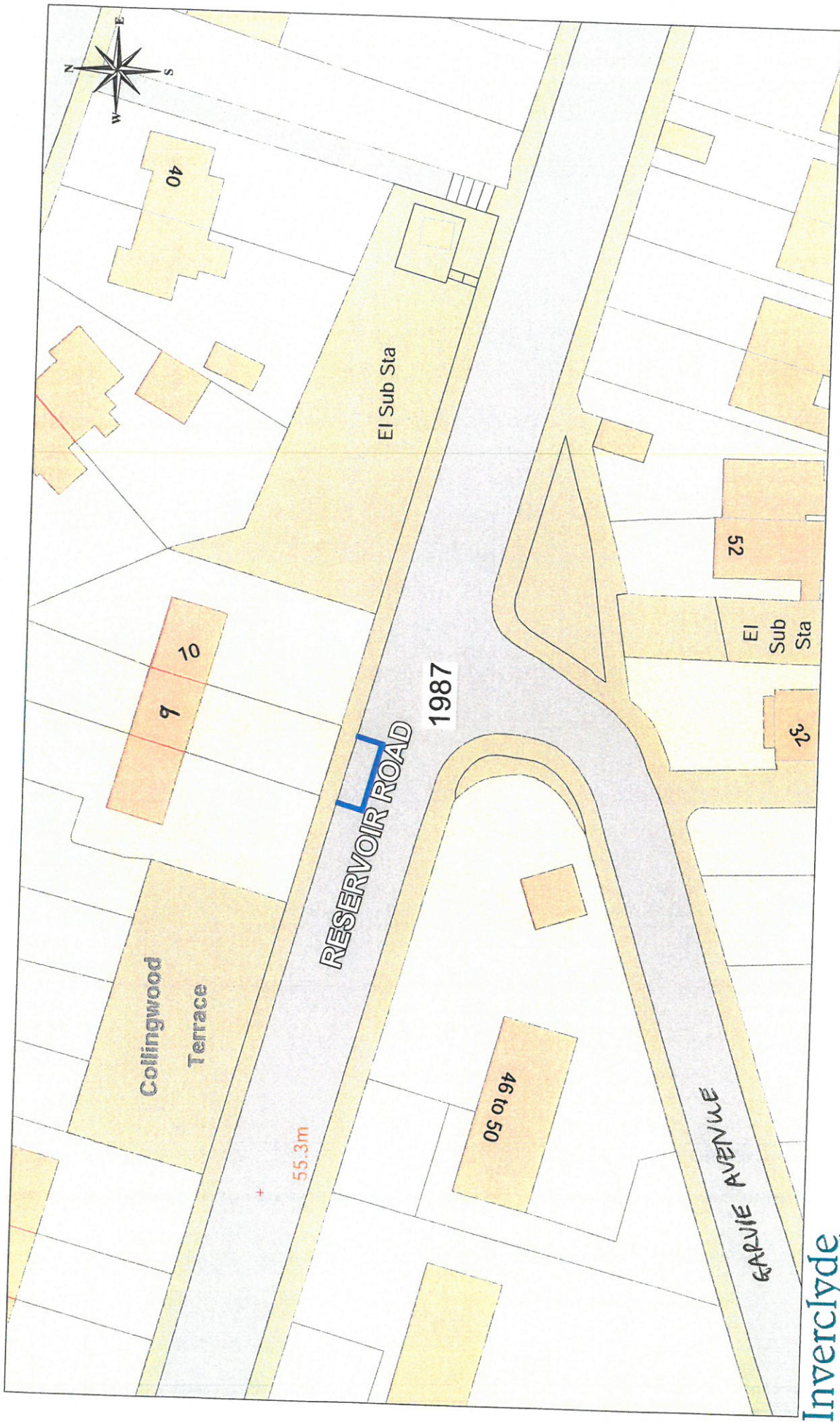

Reproduced by permission of Ordnance Survey on behalf of HMSO.
 ©Crown copyright and database right 2019.
 All rights reserved.

Inverclyde
 council

Roads & Transportation

Environment, Regeneration & Resources
 Corporate Director: Scott Allan BSc., C.Eng., M.I.C.E.
 Municipal Buildings
 Clyde Square
 Greenock, PA15 1LY
 Tel: 01475 712712
 Fax: 01475 712731
 scott.allan@inverclyde.gov.uk

DISABLED PERSONS' PARKING PLACE
 9 COLLINGWOOD TERRACE, GOUROCK
 PLACE No. 1987

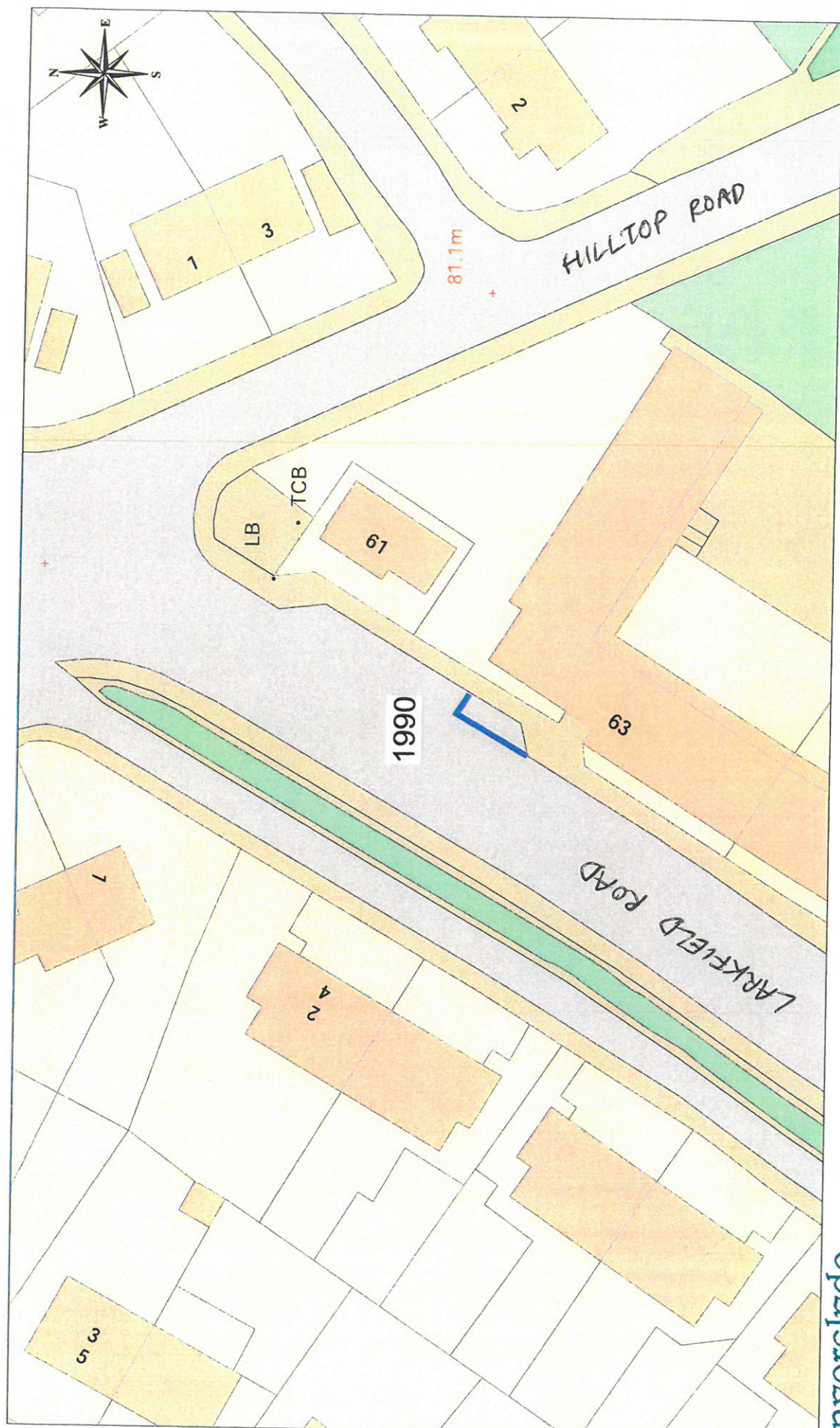

Reproduced by permission of Ordnance Survey on behalf of HMISO.
 ©Crown copyright and database right 2019.
 All rights reserved.
 Ordnance Survey Licence number 10023421.

Inverclyde
 council
 Roads & Transportation

Environment, Regeneration & Resources
 Corporate Director: Scott Allan BSc., C. Eng., M.I.C.E.
 Municipal Buildings
 Clydeside Square, PA15 1LY
 Glasgow, G4 7JZ
 Tel: 01475 712712
 Fax: 01475 712731
 scott.allan@inverclyde.gov.uk

DISABLED PERSONS' PARKING PLACE
 63 LARKFIELD ROAD, GOUROCK
 PLACE No. 1990

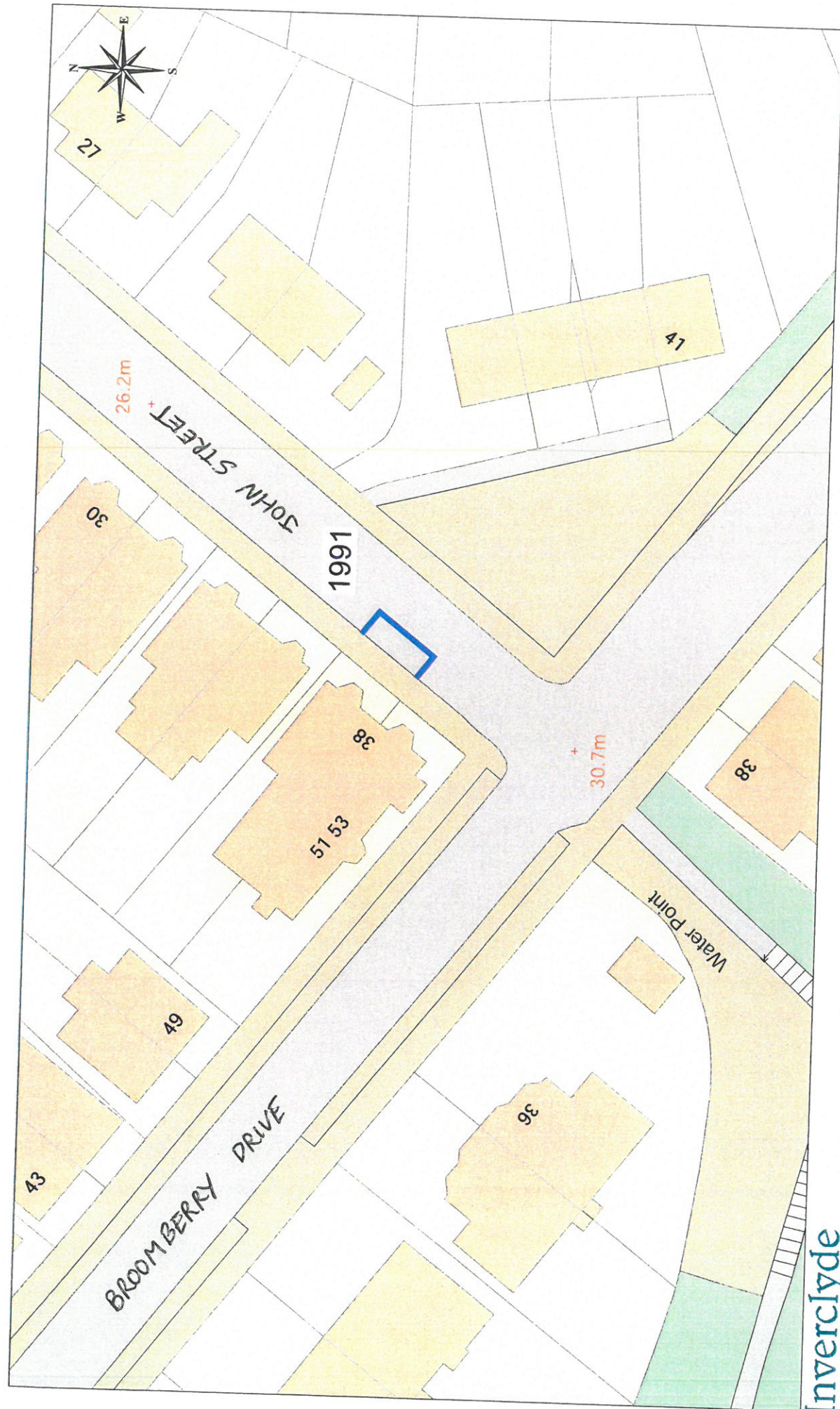

Reproduced by permission of Ordnance Survey on behalf of HMSO.
 ©Crown copyright and database right 2019.
 All rights reserved.

Inverclyde
 council

Roads & Transportation

Environment, Regeneration & Resources
 Corporate Director: Scott Allan BSc., C.Eng., M.I.C.E.
 Municipal Buildings
 Clyde Square
 Greenock, PA15 1LY
 Tel: 01475 712712
 Fax: 01475 712731
 scott.allan@inverclyde.gov.uk

DISABLED PERSONS' PARKING PLACE
 38 JOHN STREET, GOUROCK
 PLACE No. 1991

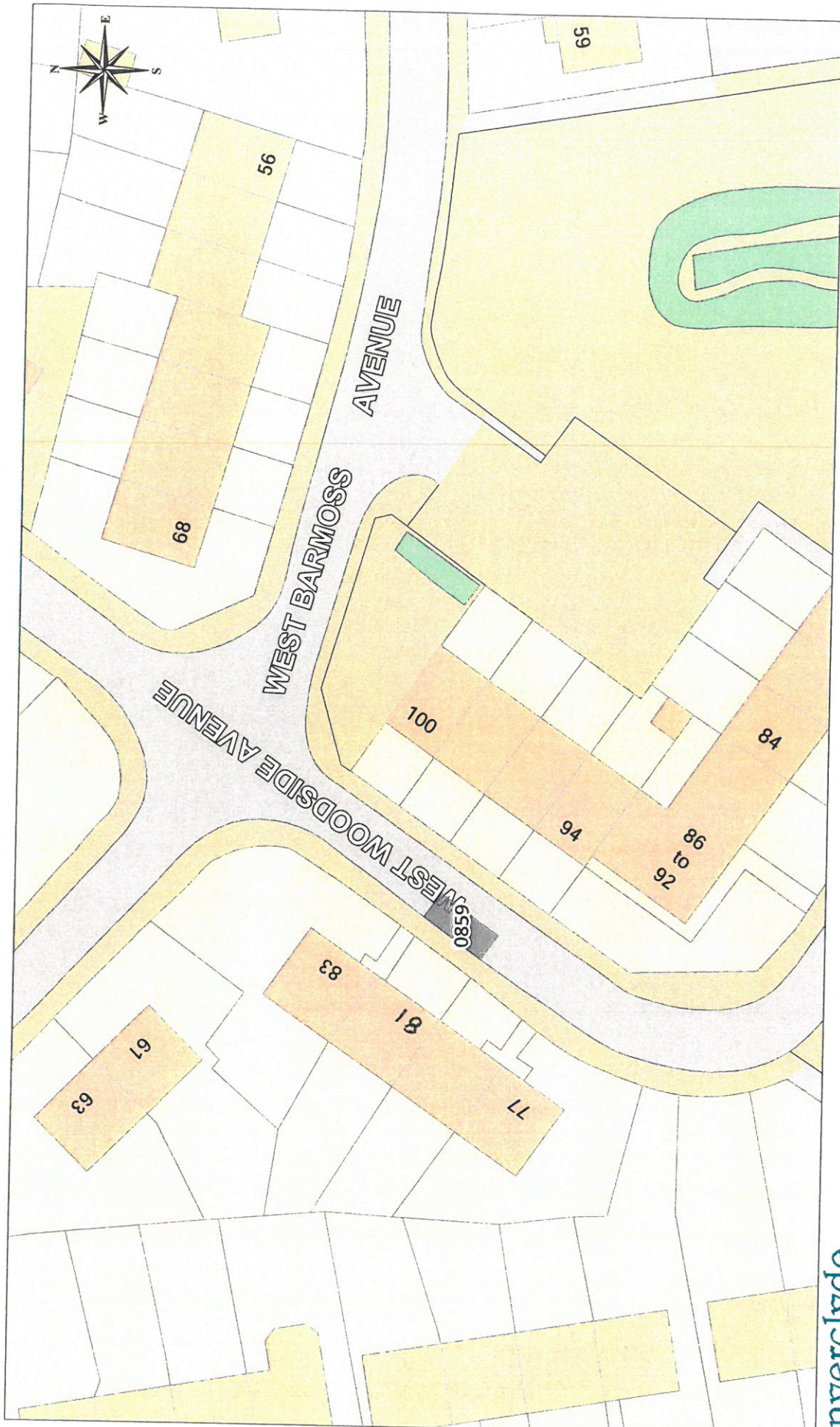

Reproduced by permission of Ordnance Survey on behalf of HMISO.
 ©Crown copyright and database right 2019.
 All rights reserved.
 Ordnance Survey Licence number 10023421.

Inverclyde
 council
 Roads & Transportation

Environment, Regeneration & Resources
 Corporate Director: Scott Allan BSc., C.Eng., M.I.C.E.
 Municipal Buildings
 Clyde Square
 Greenock, PA15 1LY
 Tel: 01475 712712
 Fax: 01475 712731
 scott.allan@inverclyde.gov.uk

DISABLED PERSONS' PARKING PLACE
81 WEST WOODSIDE AVE, PORT GLASGOW
PLACE No. 0859 REVOCATION





Disabled Bays
 HEAD OF SERVICE
 ALAN G BARNES MCIWM CEMV
 71 EAST HAMILTON STREET
 GREENOCK, PA15 2UA

Reproduced from Ordnance Survey mapping with the permission of the Controller of Her Majesty's Stationery Office. Crown Copyright. All rights reserved. No reproduction in any form is permitted without the prior written permission of Ordnance Survey and may result in prosecution or legal proceedings.
 Licence No. LA03097L

DISABLED PERSONS' PARKING PLACE
 54 BROADFIELD AVENUE, PORT GLASGOW
 PLACE No. 1032 REVOCATION

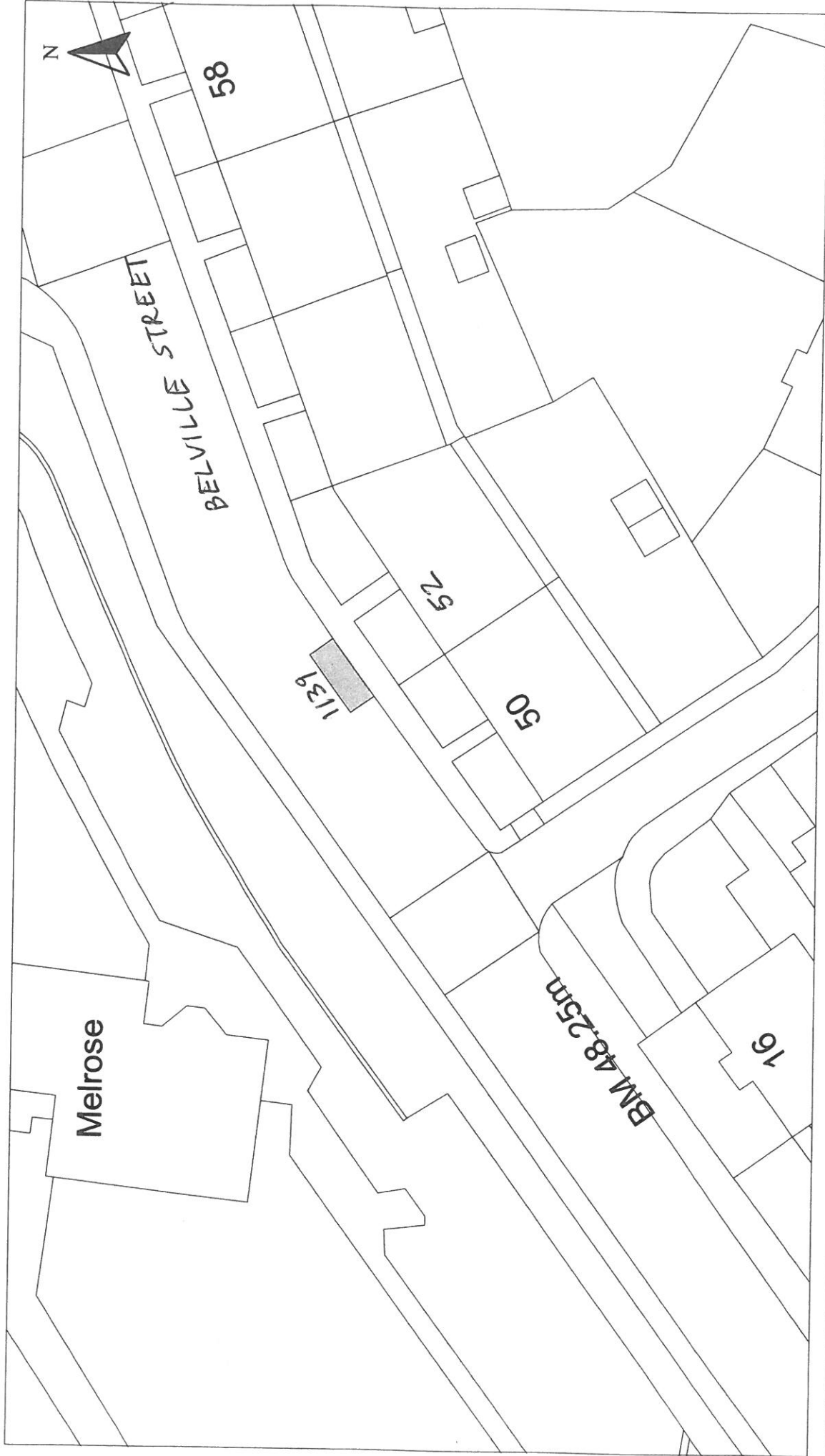
Scale : 1:500
 Prepared by : R. MACKAY
 Drawn by : R. MACKAY
 Drawing No. :
 Date : JULY 2010
 Checked by :
 Approved by :
 File No. : 19/12



Disabled Bays HEAD OF SERVICE IAN MOFFAT 71 EAST HAMILTON STREET GREENOCK, PA15 2UA	Scale : 1:500 Prepared by : R. MACKAY Drawn by : R. MACKAY Drawing No. :		Date : AUG 2011 Checked by : Approved by : File No. : 19/12
	DISABLED PERSONS' PARKING PLACE 52 BELVILLE STREET, GREENOCK PLACE No. 1139 REVOCATION		
Reproduced from Ordnance Survey mapping with the permission of the Controller of Her Majesty's Stationery Office. Crown Copyright. Unauthorised reproduction infringes Crown Copyright and may result in prosecution or legal proceedings.		Licence No. LA03097L  Ordnance Survey	

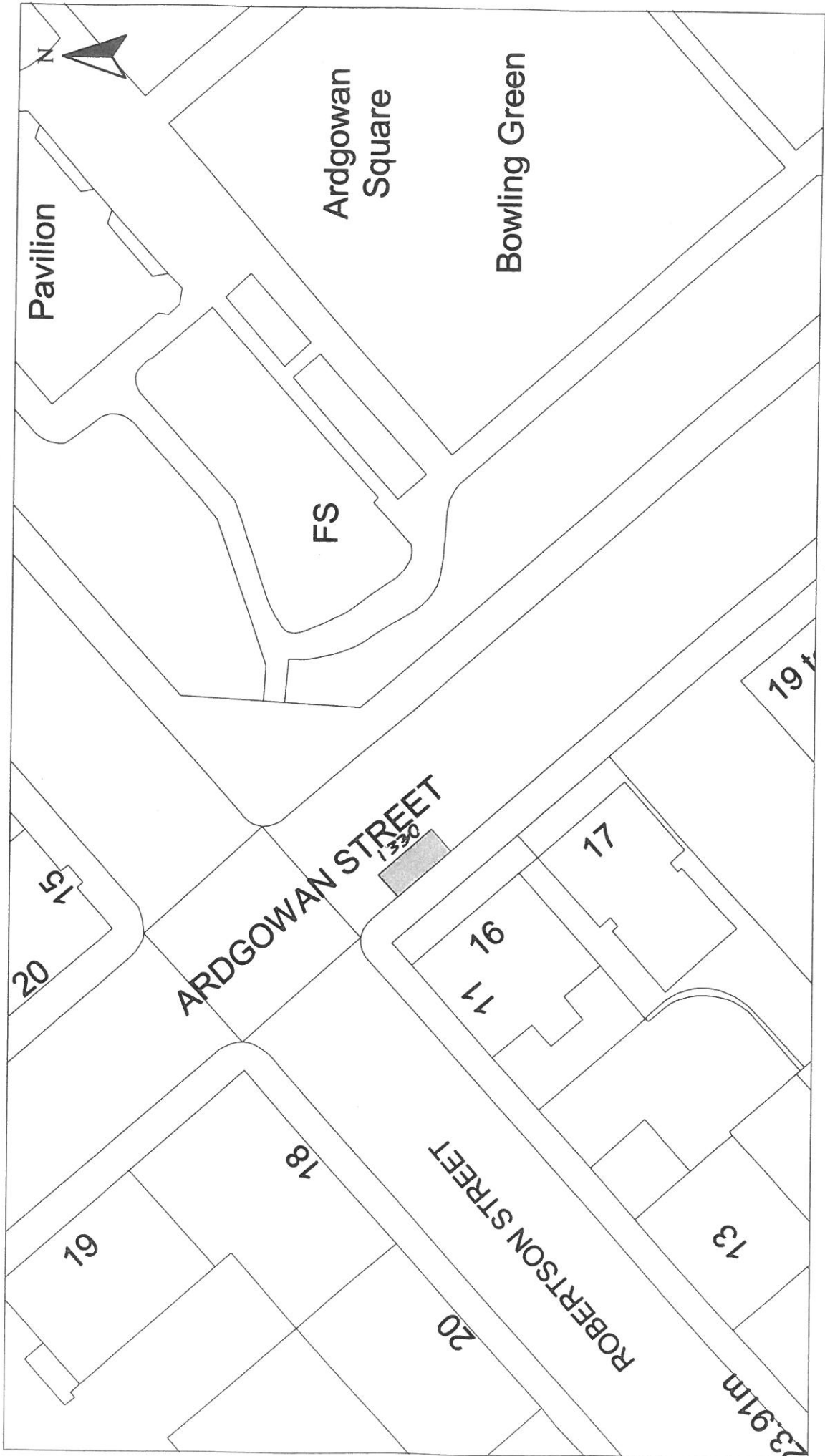

Disabled Bays	HEAD OF SERVICE IAN MOFFAT		Scale : 1:500		Date : JULY 2013
	71 EAST HAMILTON STREET GREENOCK, PA15 2UA		Prepared by : R. MACKAY		Checked by :
			Drawn by : R. MACKAY		Approved by :
			Drawing No. :		File No. : 19/12
DISABLED PERSONS' PARKING PLACE 16 ARDGOWAN SQUARE, GREENOCK PLACE No. 1330 REVOCATION					
Reproduced from Ordnance Survey mapping with the permission of the Controller of Her Majesty's Stationery Office. Crown Copyright. Unauthorised reproduction infringes Crown Copyright and may result in prosecution or legal proceedings.					
Licence No. LA03097L  Ordnance Survey					

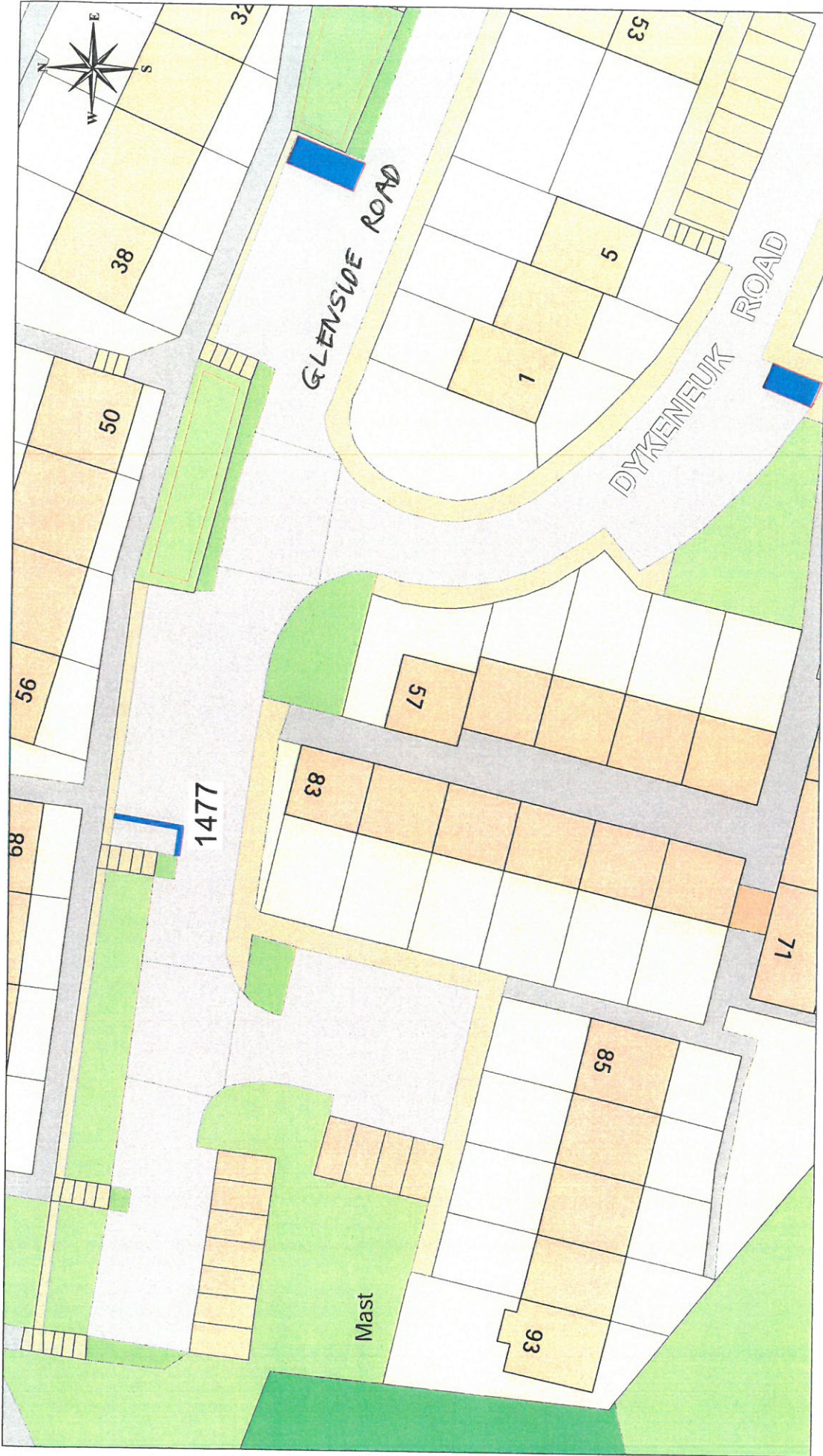

 Licensed System Supplier
 This material has been reproduced from
 Ordnance Survey maps, data with
 the permission of the Controller of
 Her Majesty's Stationery Office.
 © Crown copyright.
 Licence Number: 100029421

DISABLED PERSONS' PARKING PLACE
56 GLENSIDE ROAD, PORT GLASGOW
PLACE No. 1477 REVOCATION

Inverclyde
 council
Environmental Services
 Regeneration & Environment
 Corporate Director: Aubrey Fawcett
 Municipal Buildings
 Clyde Square
 Greenock
 PA15 1LY
 Tel: 01475 712712
 Fax: 01475 712731
 aubrey.fawcett@inverclyde.gov.uk



DISABLED PERSONS' PARKING PLACE
 60 NELSON ROAD, GOUROCK
 PLACE No. 1541 REVOCATION

Inverclyde
 council
Environmental Services

Regeneration & Environment
 Corporate Director: Aubrey Fawcett
 Municipal Buildings
 Clyde Square
 Greenock
 PA15 1LY
 Tel: 01475 712712
 Fax: 01475 712731
 aubrey.fawcett@inverclyde.gov.uk

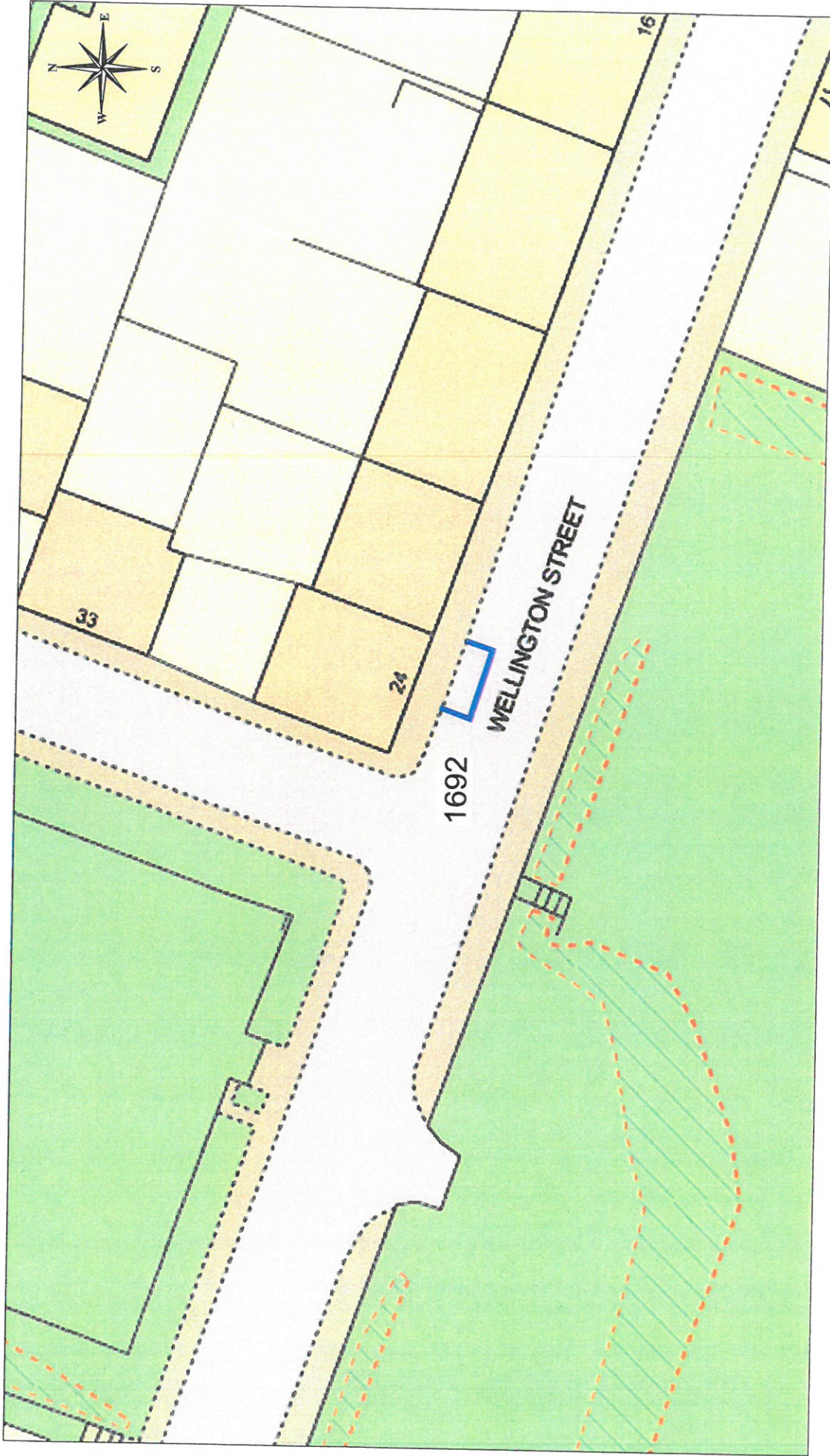

 Ordnance Survey
 Licensed System Supplier
This material has been reproduced from Ordnance Survey digital map data with the permission of Ordnance Survey on behalf of Her Majesty's Stationery Office. © Crown Copyright. Licence Number: 10003421

DISABLED PERSONS' PARKING PLACE
24B WELLINGTON STREET, GREENOCK
PLACE No. 1692 REVOCATION

Inverclyde council
Environmental Services

Regeneration & Environment
 Corporate Director: Aubrey Fawcett
 Municipal Buildings
 Clyde Square
 Greenock
 PA15 1LY
 Tel: 01475 712712
 Fax: 01475 712731
aubrey.fawcett@inverclyde.gov.uk

THE INVERCLYDE COUNCIL

**DISABLED PERSONS' PARKING PLACES
(ON-STREET) ORDER No. 1 2020**

**Statement of Reasons for Proposing to Make
the above Order**

It is considered necessary, in order to comply with Section 5 of The Disabled Persons' Parking Places (Scotland) Act 2009, to make the above Order to provide assistance for disabled persons who hold a badge under the Disabled Persons (Badges for Motor Vehicles) (Scotland) Regulations 2000 as amended and to revoke those parking places no longer required to maximise street parking capacity.

Gail MacFarlane
Shared Head of Service Roads
8 Pottery Street
GREENOCK
PA15 2UH